

1 Must be installed by a qualified electrician in accordance with all national and local electrical and construction codes and regulations. Ensure system is de-energized before installation. Review electrical plans and read all installation instructions prior to installation. Failure to comply with the following installation instructions will void the warranty and may result in serious injury or possible death. With the constant development of our products please check our website (www.modalight.com) for the latest installation guide.

La instalación debe ser realizada por un electricista cualificado, de acuerdo con todos los códigos y normativas eléctricas y de construcción nacionales y locales. Asegúrese de que el sistema esté desconectado de la corriente antes de la instalación. Revise los planos eléctricos y lea todas las instrucciones de instalación antes de la instalación. El incumplimiento de las siguientes instrucciones de instalación anulará la garantía y podría provocar lesiones graves o incluso la muerte. Debido al constante desarrollo de nuestros productos, consulte nuestro sitio web (www.modalight.com) para obtener la guía de instalación más actualizada.

L'installation doit être effectuée par un électricien qualifié, conformément à tous les codes et réglementations électriques et de construction nationaux et locaux. Assurez-vous que le système est hors tension avant l'installation. Consultez les plans électriques et lisez toutes les instructions d'installation avant l'installation. Le non-respect des instructions d'installation suivantes annulera la garantie et peut entraîner des blessures graves, voire mortelles. Nos produits étant en constante évolution, veuillez consulter notre site web (www.modalight.com) pour obtenir le guide d'installation le plus récent.

WET LOCATION INSTALL
INSTALACIÓN EN LUGARES HÚMEDOS
INSTALLATION EN EMPLACEMENT HUMIDE

2 Verify electrical plan and ensure all hardware is present
Verificar plan electrico y verifique que todo el equipo esté presente
Vérifier le plan électrique et assurer que tout le matériel est présent

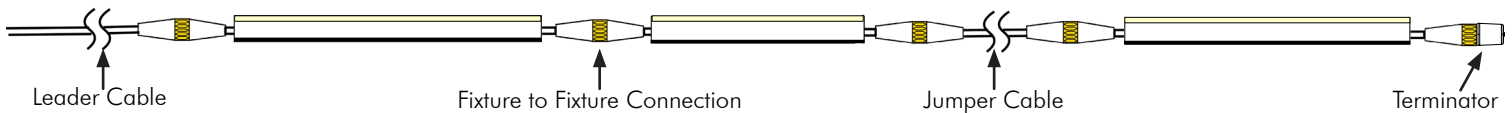

Max Continuous Run: 32ft 10 1/16" (10010mm) with a maximum of 5 electrical connections due to voltage drop
Continuidad Máxima: 32ft 10 1/16" (10010mm) con un máximo de 5 conexiones eléctricas por caída de tensión
Run Continue Max: 32ft 10 1/16" (10010mm) avec un maximum de 5 connexions électriques en raison d'une chute de tension

3 Compatible driver list
Lista de controladores compatibles
Liste des pilotes compatibles

Driver	Voltage Range	Wattage	IP Rating	Max Load
MPND96	120-277V AC	96W	IP66	32ft 10 1/16" (10010mm) Per Driver
MP96	120-277V AC	96W		
MPJB962	120-277V AC	96W x 2		
MPJB963	120-277V AC	96W x 3		
MPJB964	120-277V AC	96W x 4		
MPJB965	120-277V AC	96W x 5		
MPJB966	120-277V AC	96W x 6		
MPJB967	120-277V AC	96W x 7		

4 Voltage Drop
Caída de tensión
Chute de tension

Length	W/ft	Wattage	Length	W/ft	Wattage
1	2.43	2.43	17	2.43	41.43
2	2.43	4.86	18	2.43	43.74
3	2.43	7.29	19	2.43	46.17
4	2.43	9.72	20	2.43	48.6
5	2.43	12.15	21	2.43	51.03
6	2.43	14.58	22	2.43	53.46
7	2.43	17.01	23	2.43	55.89
8	2.43	19.44	24	2.43	58.32
9	2.43	21.87	25	2.43	60.75
10	2.43	24.3	26	2.43	63.18
11	2.43	26.73	27	2.43	65.61
12	2.43	29.16	28	2.43	68.04
13	2.43	31.59	29	2.43	70.47
14	2.43	34.02	30	2.43	72.9
15	2.43	36.46	31	2.43	75.33
16	2.43	38.88	32	2.43	77.76

5 Connection Orientations
Orientaciones de conexión
Orientations de connexion

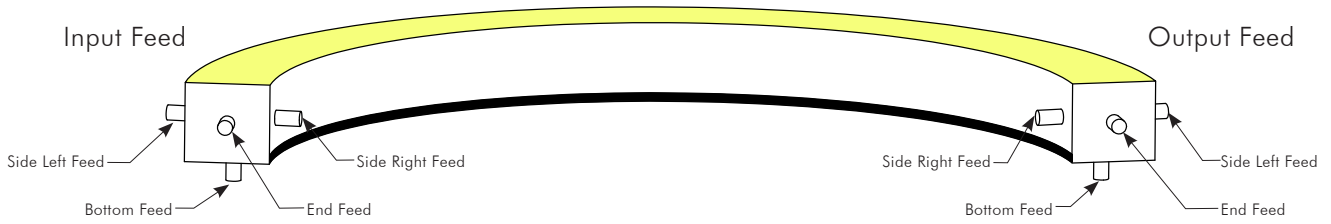

6 Cable Care
Cuidado de cables
Entretien des câbles

Ensure the cable sheath remains scratch-free to prevent water ingress
Maintain the cable at the joint in its natural, unstressed state with approximately 13/16" (20mm) of length

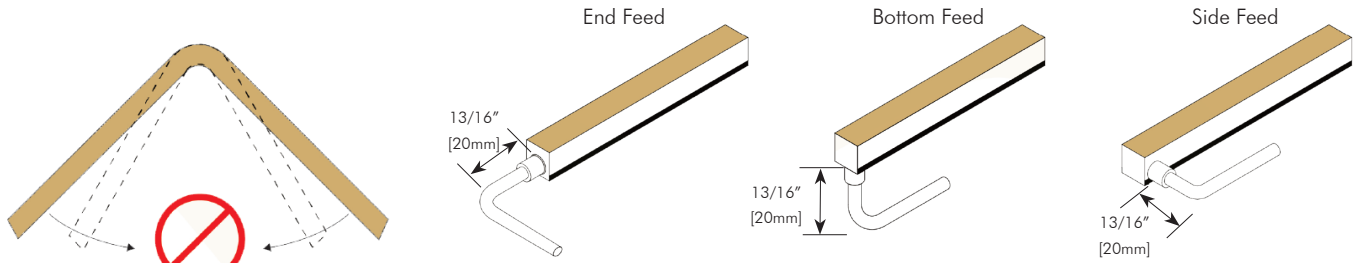

Notes:

- Never pull on the cable.
- Do not apply adhesive to the connector when attaching it to a surface, as this may cause tearing, leading to water ingress and product failure.
- Except for end feed, maintain a 13/16" (20 mm) gap from a track. Close contact may damage the connector from expansion, causing water ingress and product failure.

7 Bend Specifications
Especificaciones de curvatura
Spécifications de pliage

Unlike conventional flexible fixtures restricted to a single bending axis, the MODA 3D Flex Mini Direct View is engineered for multi-axis flexibility, enabling both horizontal and vertical articulation to accommodate complex architectural geometries. Care must be taken to ensure that all bends remain within the maximum horizontal and vertical bend radius specified in this document to prevent mechanical stress or damage to the fixture.

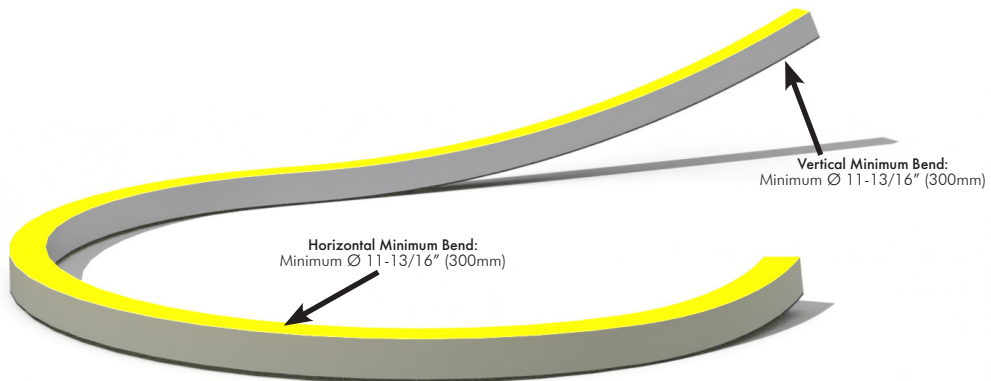

8 3D Bendable Track

Montaje de riel flexible en 3D
Montage de rails flexibles en 3D

The 3D Bendable Track flexes both horizontally and vertically, allowing effortless adaptation to curved and complex surfaces. The silicone housing enables reliable performance in harsh environments, including seaside installations.

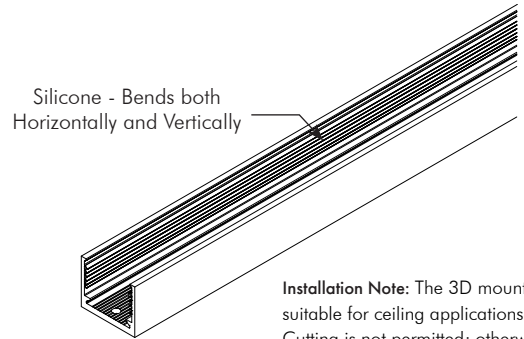
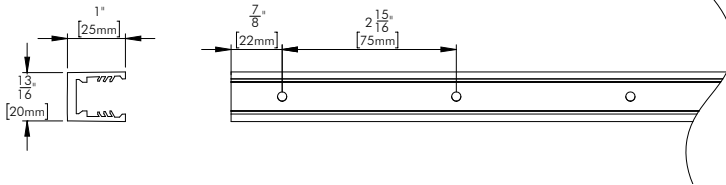

Installation Note: The 3D mounting track is not suitable for ceiling applications. Cutting is not permitted; otherwise, the metal core may rust.

9 3D Bendable Track Installation

Instalación de vías
Installation de la piste

Step 1: Mark the installation area

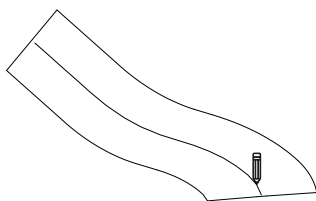

Step 2: If necessary drill a pilot hole.

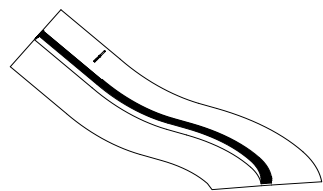

Step 3: Fasten the mounting track with appropriate fixings (by others)

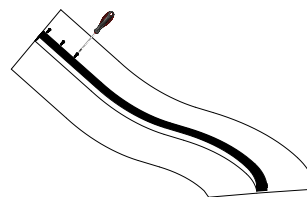

Step 4: Keep the track clear of debris before installing 3D Flex Mini Direct View to avoid damage and water ingress.

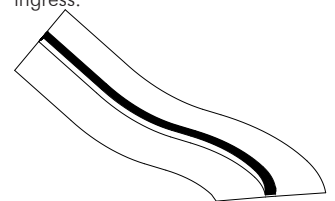

10 3D Bendable Track Mounting Notes

Notas sobre el montaje de la pista flexible 3D
Notes relatives au montage des rails flexibles 3D

Ensure the mounting surface is level before installing each 3D Bendable Track. Suitable substrates include steel, aluminum, concrete, or wood. Use hardware, bolts, or screws (supplied by others) that are properly sized for the mounting bracket bases and appropriate for the installation surface.

Ensure track is not deformed as it will not have any clamping force

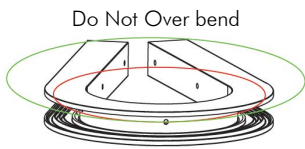

Bending Maximum	
Vertical Bending	Ø 11 13/16" (300mm)
Horizontal Bending	Ø 11 13/16" (300mm)

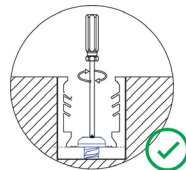

Ensure the screw is properly installed.

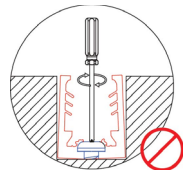

Do not over tighten the screw, as this may crush the silicone housing or deform the track internal structure.

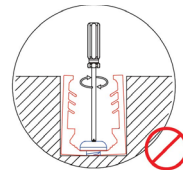

No cutting is advised, otherwise the metal inside will get rusted. No extra drilling of track is permitted!

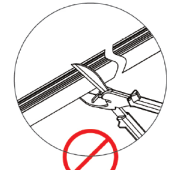

11 Expansion Gap

Brecha de expansión
Joint de dilatation

Leave around 3/16" (5mm) space between mounting track for an expansion gap.

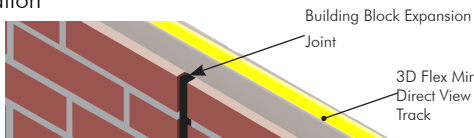

Offset 3D Flex Mini Direct View Track joints from structural expansion seams to prevent stress on the fixture.

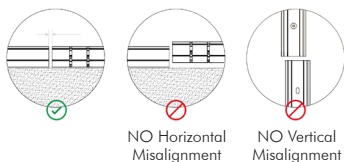

NO Horizontal Misalignment
NO Vertical Misalignment

12 Connector Placement in 3D Bendable Track

Colocación de conectores en una pista flexible tridimensional.
Positionnement des connecteurs dans une piste flexible en 3D

When using the 3D Bendable Track, connectors may be installed inside the track as needed, except for connectors with bottom cable entry or side cable entry.

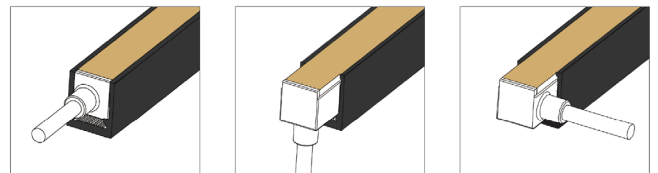

13 Fixed and Bendable Track Fabrication

Fabricación de rieles fijos y flexibles

Fabrication de rails fixes et flexibles

Cut the mounting track to the desired length.

If the section end is 3 15/16" (100 mm) from the hole, drill a 3/16" (5 mm) hole about 13/16" (20 mm) from the end to securely fasten the track.

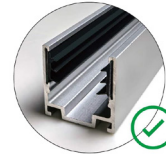
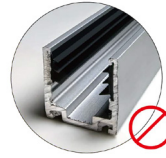
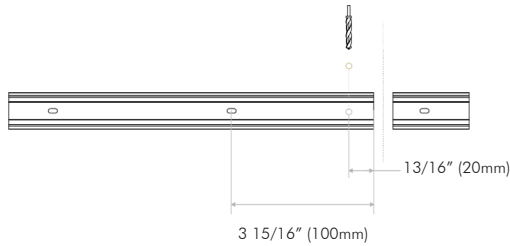

Ensure there is no debris inside the track
Do not use deformed track
Ensure screw heads are straight and in-line the base of the track

De-burr edges after cutting to protect the 3D Flex Mini Direct View and prevent water ingress.

14 Expansion Gap

Brecha de expansión

Joint de dilatation

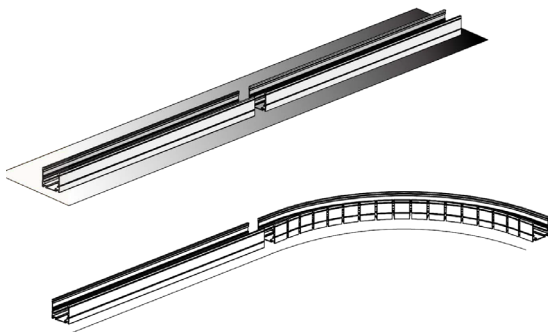

Leave around 3/16" (5mm) space between mounting track for an expansions gap.

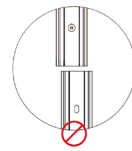
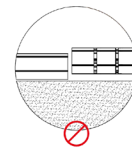
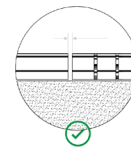

Offset 3D Flex Mini Direct View Track joints from structural expansion seams to prevent stress on the fixture.

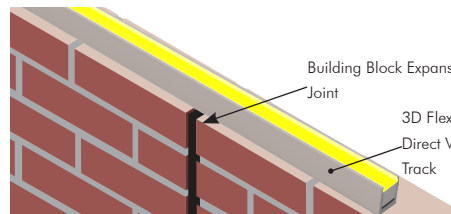

15 Fixed and Bendable Track Installation

Instalación de rieles fijos y flexibles

Installation de rails fixes et flexibles

Step 1: Mark the installation area, then position the mounting tracks along the outline.

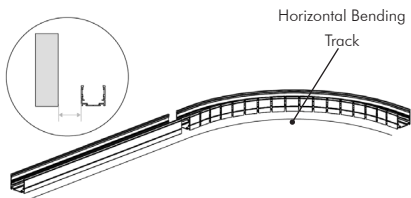

Step 2: Mark the fixing holes.

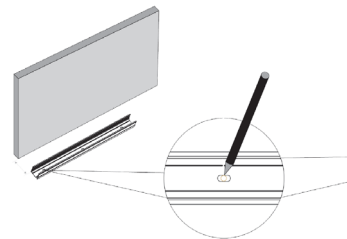

Step 3: If necessary drill a pilot hole.

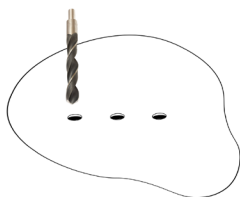

Step 4: Fasten the mounting track with appropriate fixings (by others)

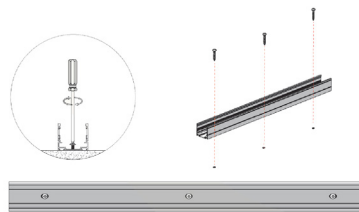

Keep the track clear of debris before installing 3D Flex Mini Direct View to avoid damage and water ingress.

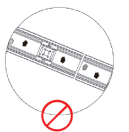

16

Surface-Mounted Raceway Aluminum Track

Pista de aluminio para canalización de superficie
Piste en aluminium montée en surface

Note: This track is best suited for end feed 3D Flex Mini Direct View

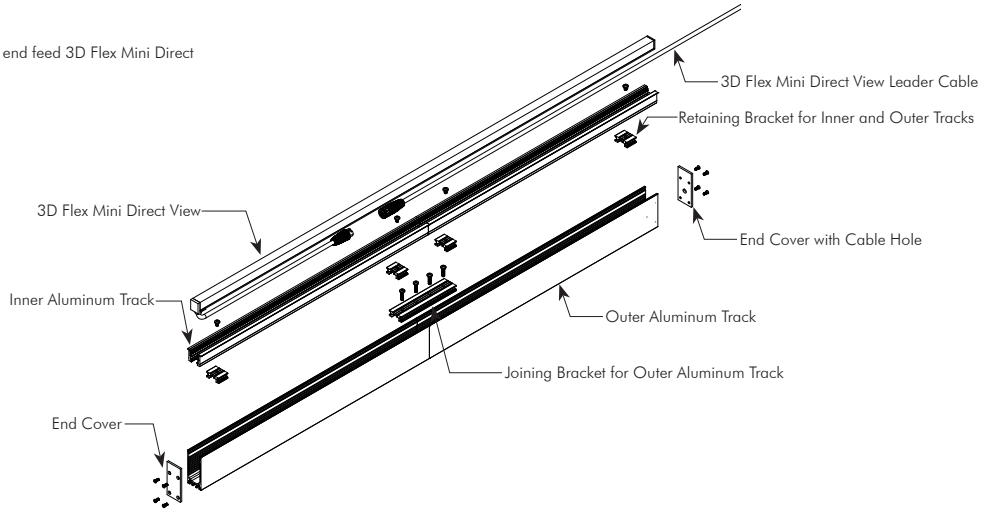

17

Surface-Mounted Raceway Aluminum Track Installation

Instalación de rieles de aluminio para canalización de superficie
Installation de rails en aluminium montés en surface

Step 1: Mark the installation area and then fix the outer aluminum track.

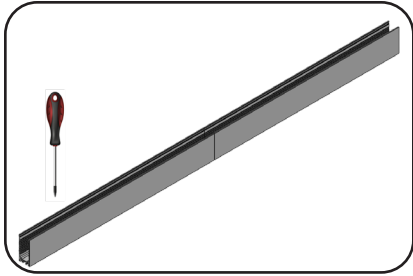

Step 3: Tighten the screws at the bottom of the outer aluminum track until fully secured.



Step 5: Insert the inner aluminum track in the rearranged sequence to maintain a staggered installation with the outer track. Verify the notch direction before installation. Tighten the screws through the retaining bracket to secure the inner aluminum track.

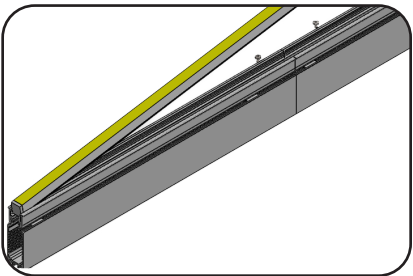

Step 2: If needed, insert the joining bracket into the bottom slot of outer track and centered for the length extension.

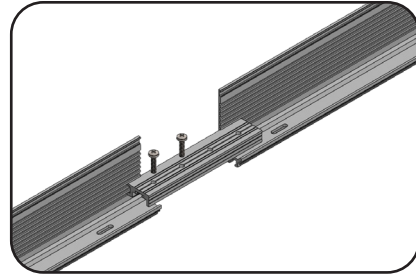

Step 4: Route the wiring under the retaining bracket and over the joining bracket.

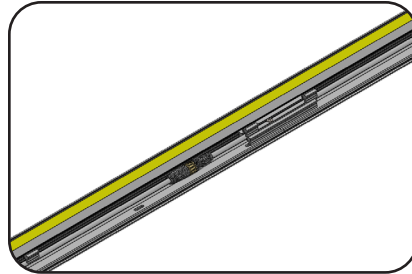

Step 6: Press the light into place using even palm pressure and gently organize any excess cable. Seal the front connector with the end cover without a cable hole and tighten the screws. Thread the cable through the hole and seal the opposite end in the same manner.

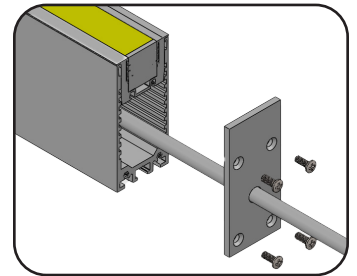
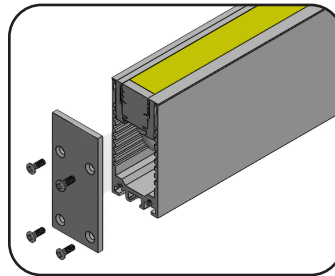

18

Pivot Mounting Bracket

Soporte de montaje pivotante
Support de montage pivotant

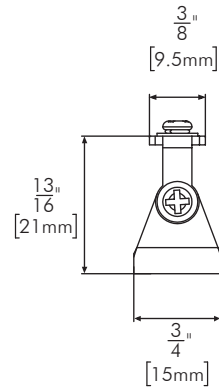
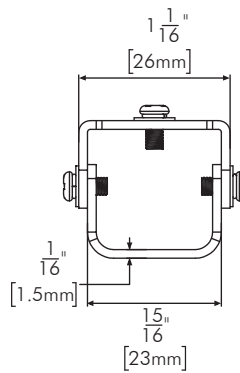

19

Pivot Mounting Bracket Installation

Instalación del soporte de montaje giratorio
Installation du support de montage pivotant

Step 1: Remove the upper screw from pivot mounting bracket.

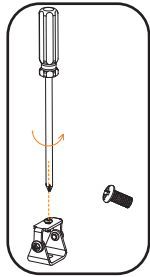

Step 2: Secure the pivot mounting bracket to the mounting track using the screw.

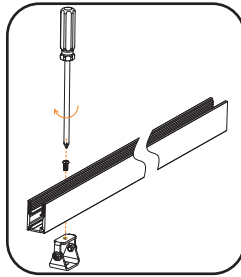

Step 3: Repeat Steps 1 and 2 for all remaining brackets. Ensure each mounting track has at least two locking points, preferably at equal intervals.

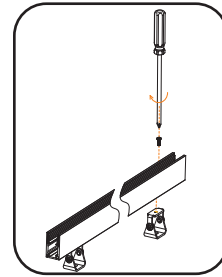

Step 4: Rotate the pivot mounting bracket until the unused screw hole is exposed, allowing alignment with the pre-marked hole on the mounting surface.

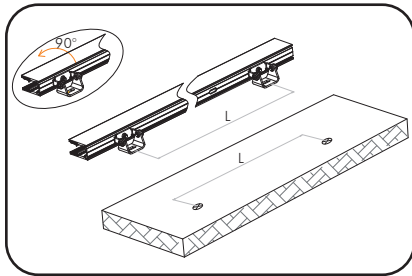

Step 5: Fix pivot mounting bracket to mounting surface.

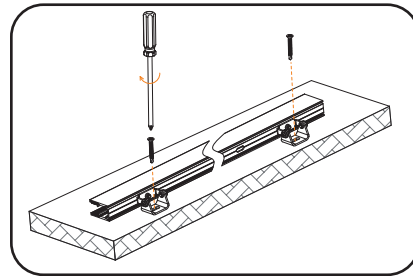

Step 6: Adjust the mounting track to the required angle.

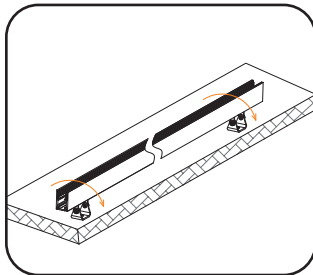

Step 7: Tighten the side screws on the pivot mounting bracket to prevent loosening of the locking point.

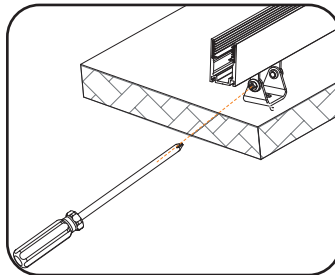

Warning: Ensure that the pivot mounting bracket and the mounting track remain parallel in the side view.

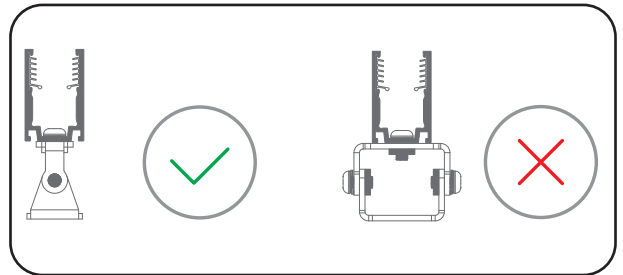

20

Rotary Locking Bracket

Soporte de bloqueo giratorio
Support de verrouillage rotatif

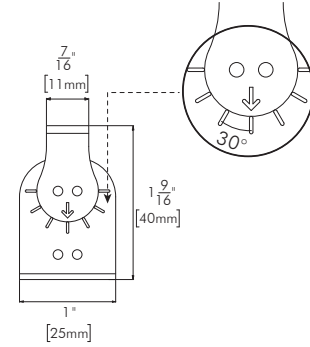
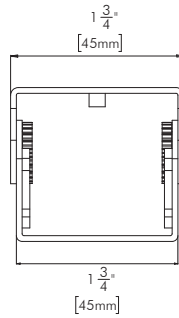
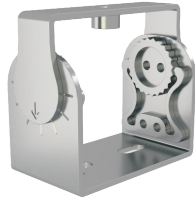

21

Rotary Locking Bracket Installation

Instalación del soporte de bloqueo giratorio
Installation du support de verrouillage rotatif

Step 1: Mark the installation position on the mounting surface.

Step 2: Fix the mounting track to the rotary locking bracket by screws.

Step 3: Set the mounting track aside and secure the rotary locking bracket to the mounting surface with screws along the marking line.

Step 4: Return the mounting track to its original position. If you are extending the length—one light fitting across multiple mounting tracks—skip ahead to step 7.

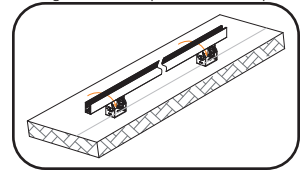
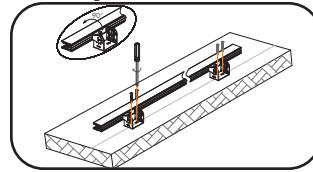
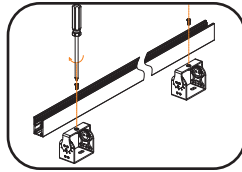
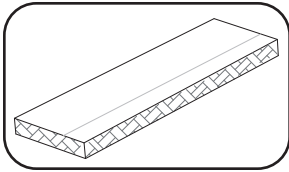

Step 5: Install the light in order, leaving the front connector and end cap outside the mounting track.

Step 6: Power on the light and rotate the mounting track to the desired lighting angle.

Step 7: Maintain a 5mm spacing between mounting tracks to accommodate expansion and contraction.

Step 8: Fit the light into the first piece of mounting track and keep the remaining lights coiled. Next repeat step 6 to adjust the lighting angle.

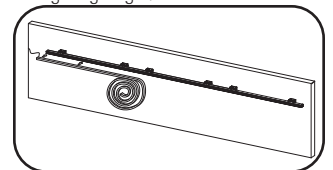
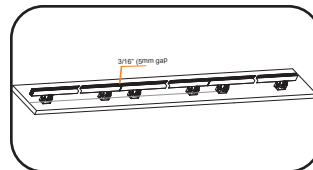
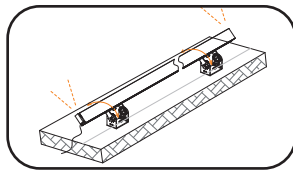
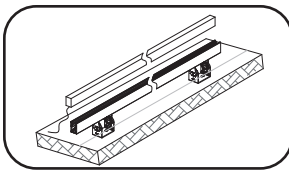

Step 9: Adjust the rest of the mounting tracks to match the same angle, and then install the coiled light in order.

Step 10: If you need further adjustment after installation, please fine tune rotary locking bracket 15 degree each time one by one in case of twisting on lights.

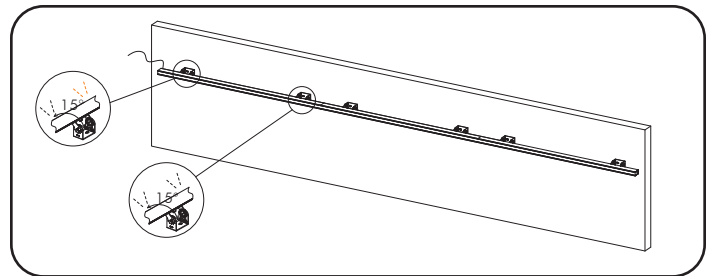
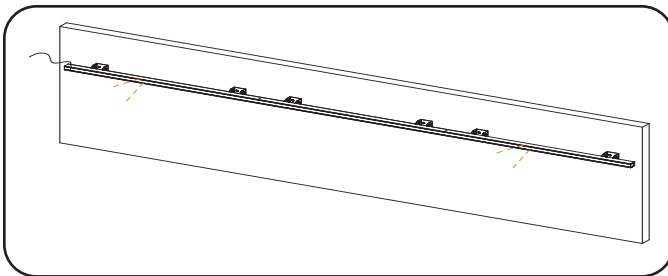

22

Ceiling Mounting Bracket

Soporte de montaje en techo
Support de fixation au plafond

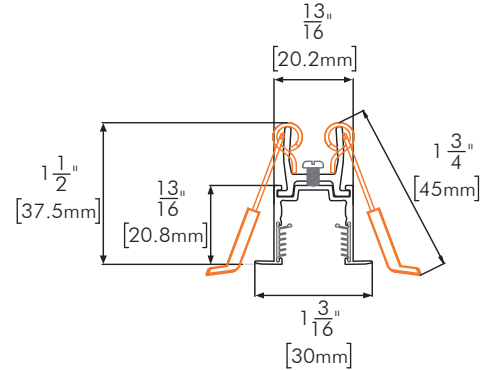
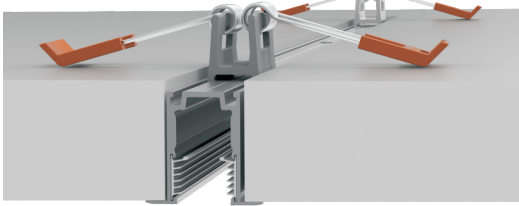

23

Ceiling Mounting Bracket Installation

Instalación del soporte de montaje en el techo
Installation du support de fixation au plafond

Step 1: Gently unfold the spring and slide it into the mounting tracks groove.

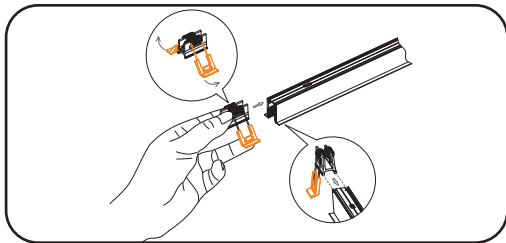

Step 3: Repeat Steps 1 and 2 for the remaining brackets, ensuring each mounting track is secured at a minimum of two locking points. Equal spacing between locking points is recommended.

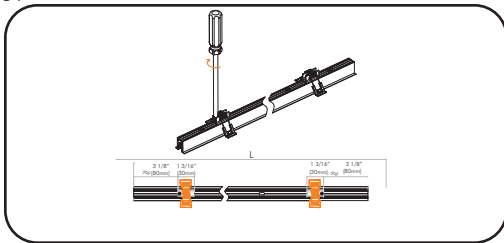

Step 5: Use your hands to hold the springs, then release them once the unit is clipped into the ceiling.

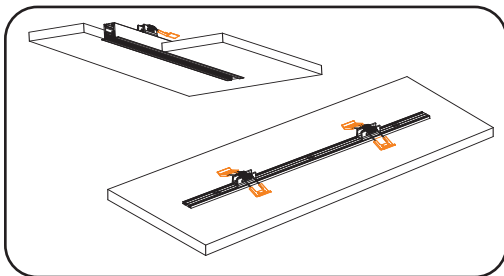

Step 2: Move the ceiling mounting bracket forward by 3 1/8" (80mm), then tighten the screw firmly.

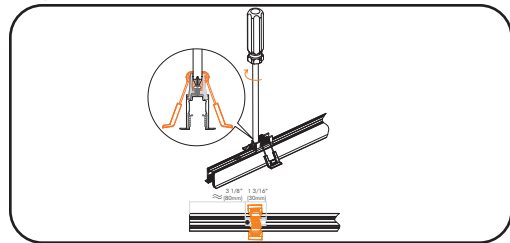

Step 4: Mark the ceiling and cut the slot as instructed.

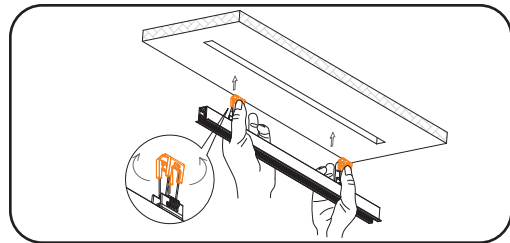

Notes: The width applicable to : 7/8" to 1" (22~25mm)
The thickness of ceiling: 3/16" to 2" (5~50mm)
Only applicable to flanged serrated aluminum track.

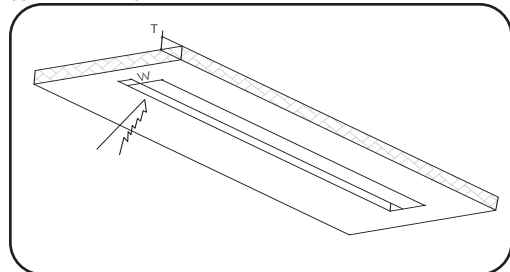

24

Suspended Raceway Aluminum Track

Pista de carreras suspendida de aluminio

Piste de course suspendue en aluminium

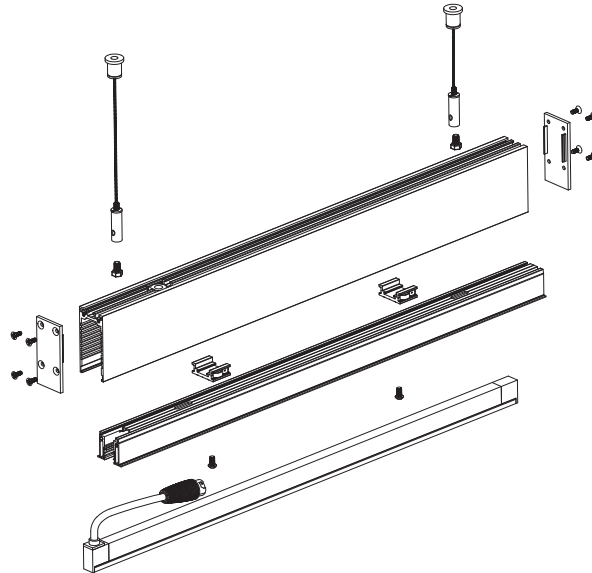

25

Suspended Raceway Aluminum Track Installation

Instalación de rieles de aluminio para canalización suspendida

Installation de la piste en aluminium suspendue

Step 1: Mark the mounting position and input end on the ceiling with sufficient load-carrying capacity.

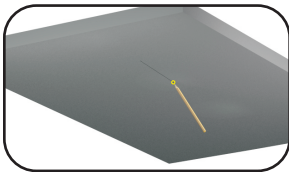

Step 2: Mount the outer portion of the cable couplers to the ceiling and secure them with screws.

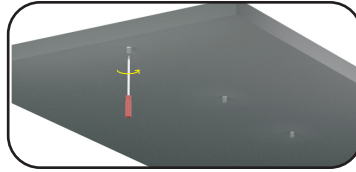

Step 3: Thread steel wire through the inner part of cable coupler and its molded stop will prevent the wire from falling out.

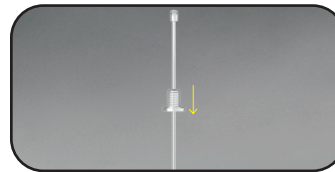

Step 4: Unscrew the coupling nut on the top of cable gripper and then push in the plunger to allow the other end of steel wire to thread through the keyhole of cable gripper.

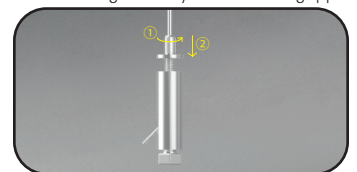

Step 5: Tighten the assembled cable grippers to the mounted outer part of cable couplers.

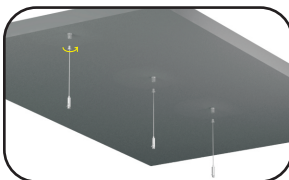

Step 6: If needed, insert the joining bracket into the bottom slot of outer tracks and centered for the length extension.

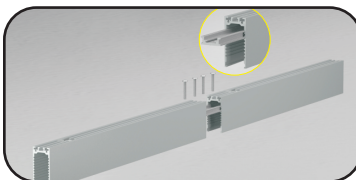

Step 7: Using the same procedure as steps 3 through 6, Surface Mounted Track installation. See page 6 section 18.

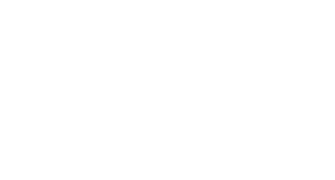

Step 8: Flip the outer aluminum tracks. Then unscrew the hex bolt of cable gripper and slide it in from the open slots where rubber grommets lay.

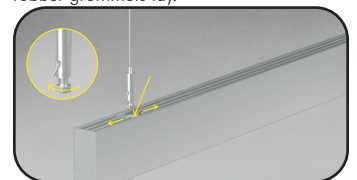

Step 9: Tighten the bushings of cable grippers with the hex bolts.

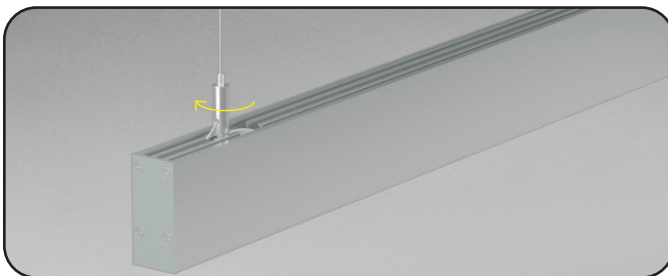

Step 10: Adjust the position of cable grippers and the length of steel wires to the desired ones, and remain all of the steel wires hanging vertically. Tighten the coupling nut the and cut or roll up the excess steel wire at last.

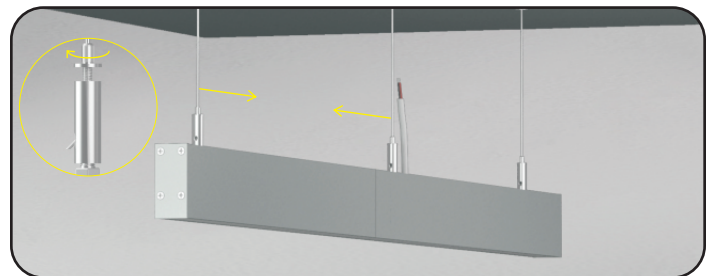

26

Suspended Mounting Rod
Varilla de montaje suspendida
Tige de montage suspendue

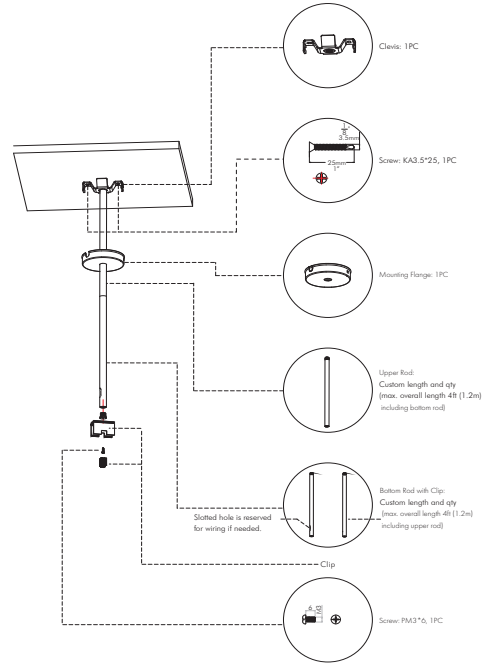
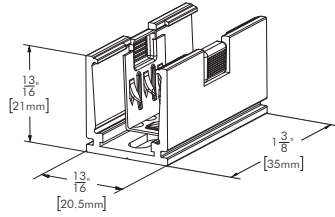
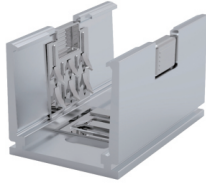

27

Suspended Mounting Rod without Wiring Installation
Varilla de montaje suspendida sin instalación de cableado
Tige de montage suspendue sans installation de câblage

Step 1: Mark the installation position of clevis on the ceiling with sufficient load-carrying capacity.

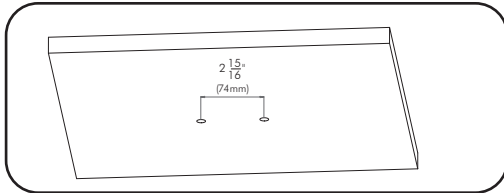

Step 3: Assemble the mounting flange and the rods in order of 1, 2 and 3.

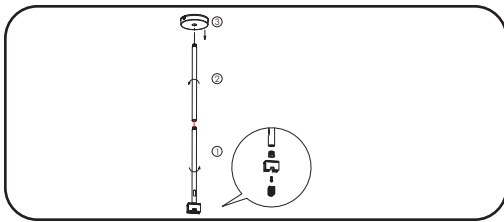

Step 5: Shield the clevis by the mounting flange and rotate anticlockwise until it clicks into place.

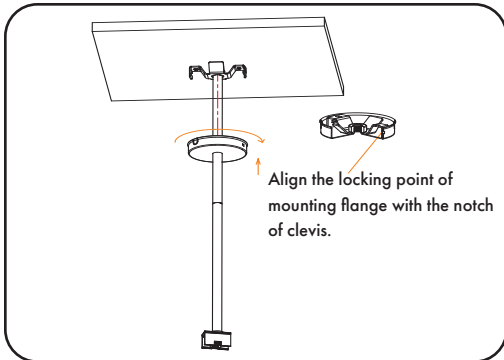

Step 2: Secure the clevis by tightening the screws.

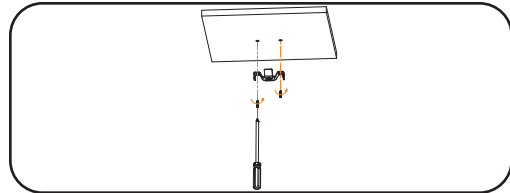

Step 4: Rotate and fasten them clockwise.

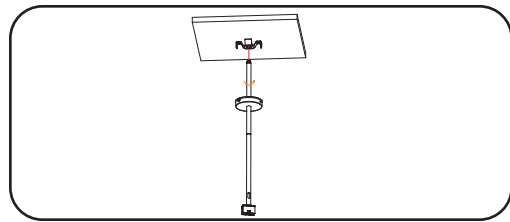

Step 6: Adjust the clip to the angle you need (max. 180° in a clockwise direction).

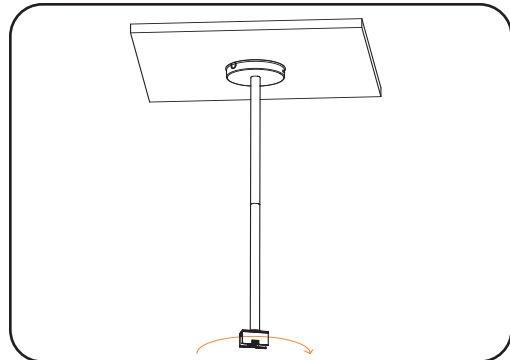

28

Suspended Mounting Rod with Surface Wiring

Varilla de montaje suspendida con cableado de superficie.

Tige de montage suspendue avec câblage apparent

Step 1: Mark the installation position of clevis on the ceiling with sufficient load-carrying capacity.

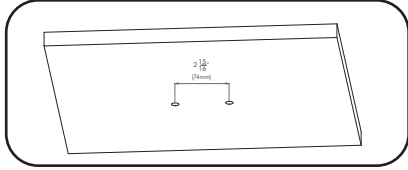

Step 4: Rotate and fasten them clockwise.

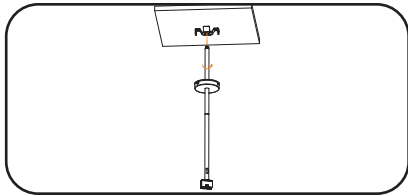

Step 7: 1 Adjust the clip to the angle you need (max. 180° in a clockwise direction).. 2 Install the light to the clip and adjust the cable length.

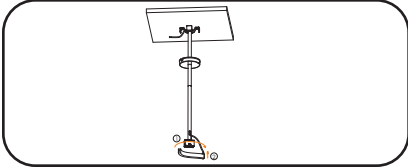

Step 2: Cut a cable hole following the pre-marked notch on the lateral side of the mounting flange.

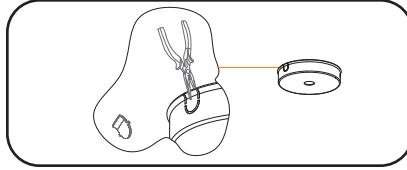

Step 5: Thread the cable through slotted hole to the top of rod.

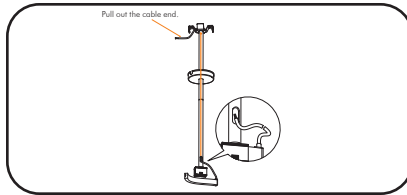

Step 8: Shield the clevis by the mounting flange and rotate anticlockwise until it clicks into place.

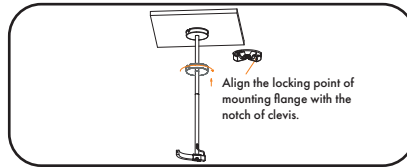

Step 3: Assemble the mounting flange and the rods in order of 1, 2, 3, 4.

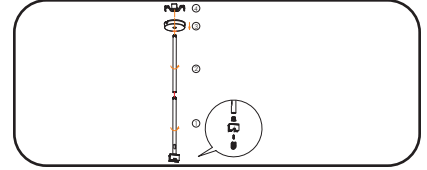

Step 6: Tighten the clevis by screws.

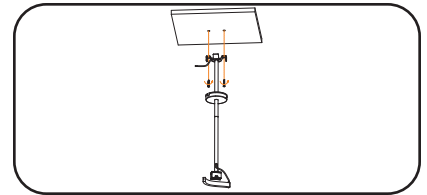

Step 9: Connect the DC 24V Power

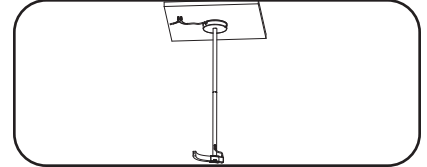

29

Suspended Mounting Rod with Concealed Wiring

Varilla de montaje suspendida con cableado de superficie.

Tige de montage suspendue avec câblage apparent

Step 1: Mark the installation position of clevis on the ceiling with sufficient load-carrying capacity, and in between punch a ø20mm cable hole.

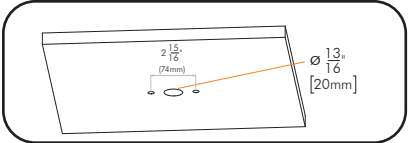

Step 4: Rotate and fasten them clockwise.

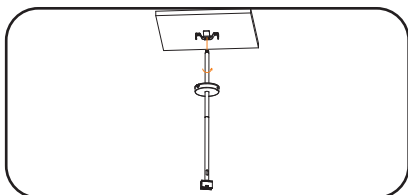

Step 7: 1 Thread the cable through holes to the inside of ceiling... 2 Install the light to the clip and adjust the cable length.

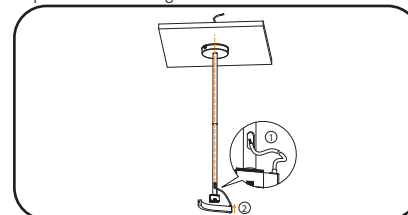

Step 2: Tighten the clevis by screws.

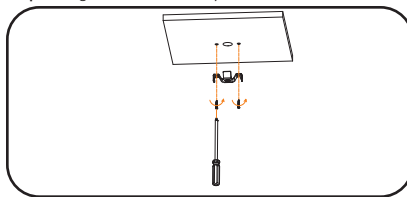

Step 5: Shield the clevis by the mounting flange and rotate anticlockwise until it clicks into place.

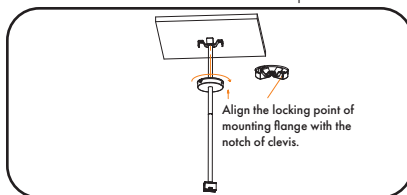

Step 8: Connect the DC 24V Power

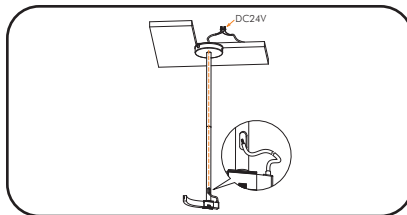

Step 3: Assemble the mounting flange and the rods in order of 1, 2, 3, 4.

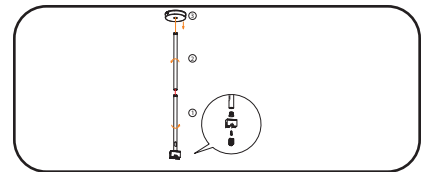

Step 6: Adjust the clip to the angle you need (max. 180° in a clockwise direction).

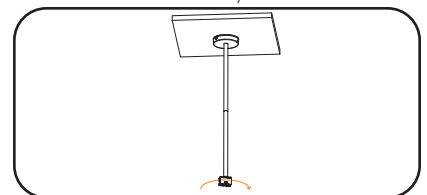

30

Suspended Mounting Wire
Cable de montaje suspendido
Fil de suspension

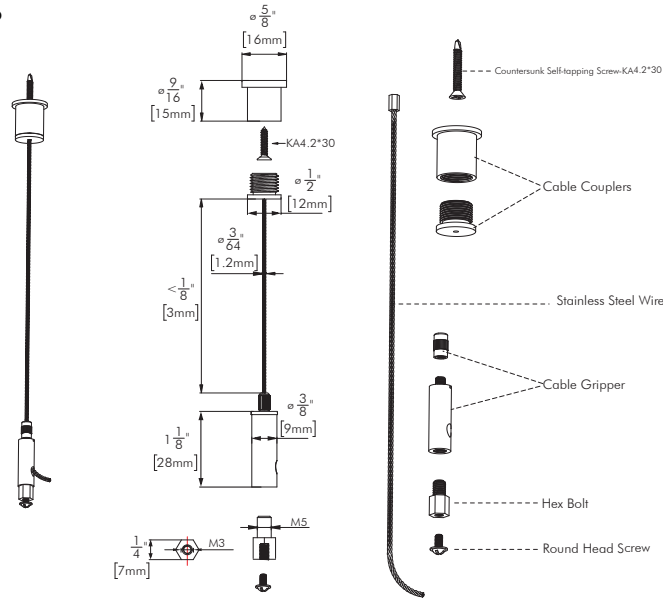

31

Suspended Mounting Wire Installation

Instalación de cable de montaje suspendido
Installation de câbles de suspension pour montage en hauteur

Step 1: Mount the attachment of cable couplers to the ceiling with sufficient load-carrying capacity and tighten them with screws.

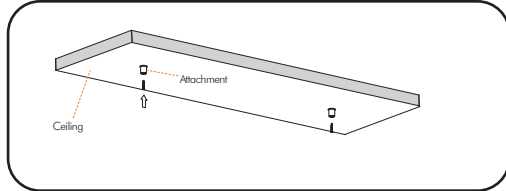

Step 3: Insert the screw into the serrated aluminum track to lock with the cable gripper sliding from the bottom slot of serrated aluminum track.

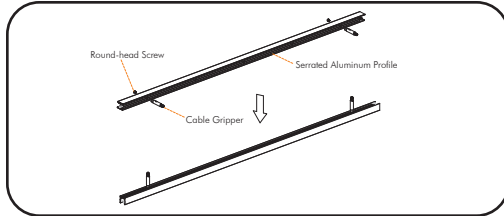

Step 5: Fix the light into the aluminum track.

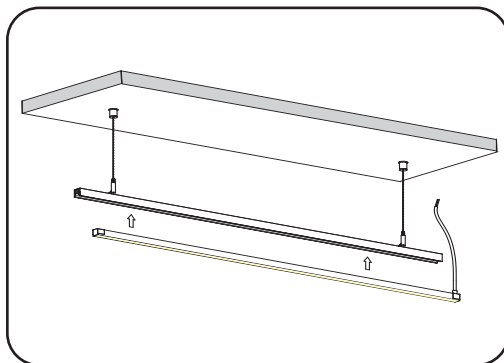

Step 2: Thread the stainless steel wire through the male screw of cable couplers and then connect to the mounted attachment of cable couplers.

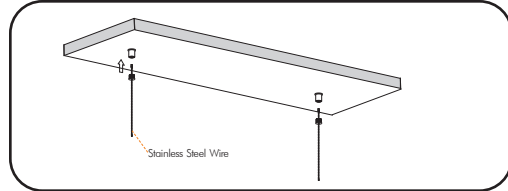

Step 4: Thread the stainless steel wire through the bushing of cable gripper.

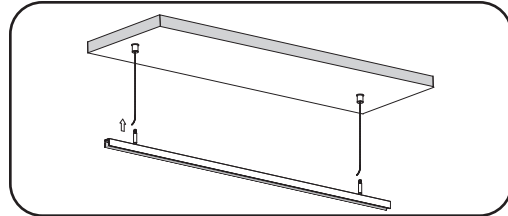

Step 6: Adjust the length of stainless steel wires to the desired height. Tighten the coupling nut and cut or roll up the excess stainless steel wires after the power-on test.

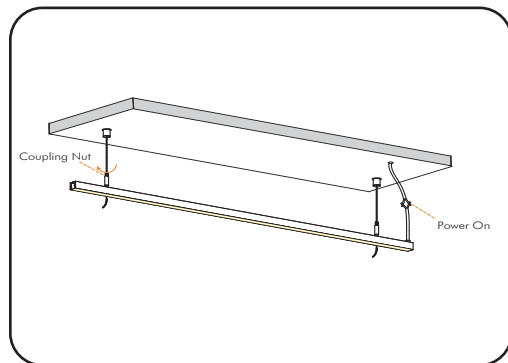

32

Side Mounting Bracket

Soporte de montaje lateral
Support de montage latéral

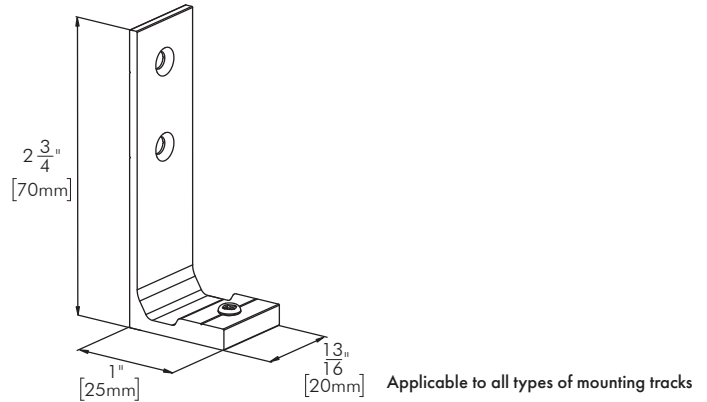

33

Side Mounting Bracket Installation

Instalación del soporte de montaje lateral
Installation du support de montage latéral

Step 1: Remove the M3x6 screw of side mounting bracket.

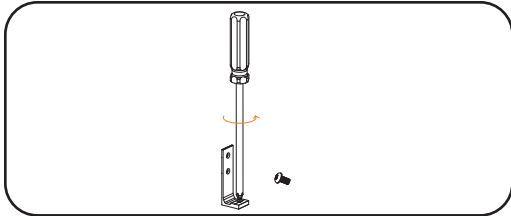

Step 3: Repeat Steps 1 and 2 for all remaining brackets. Ensure each mounting track has a minimum of two locking points, and use equal spacing whenever possible.

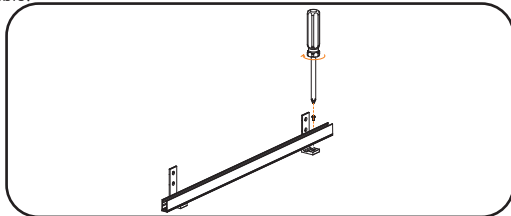

Step 5: Fix the side mounting bracket by using suitable fixings (by others).

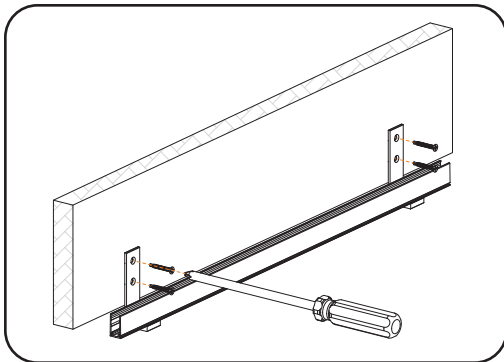

Step 2: Fix side mounting bracket and mounting track tightly by the screw.

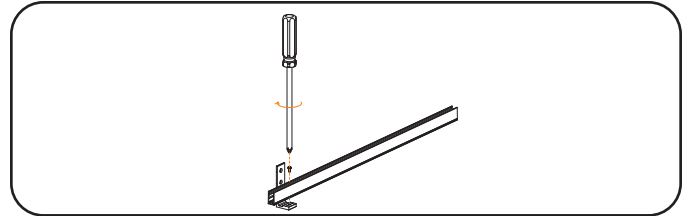

Step 4: Mark the pilot holes on mounting surface accordingly.

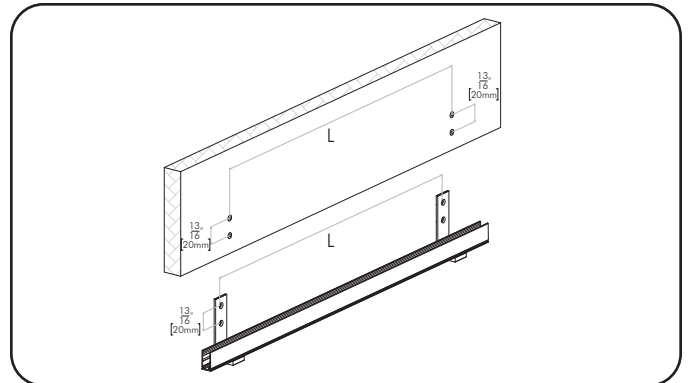

34

Bendable Mud-in Aluminum Track

Riel de aluminio flexible para empotrar en masilla
Rail en aluminium cintrable à encastrer

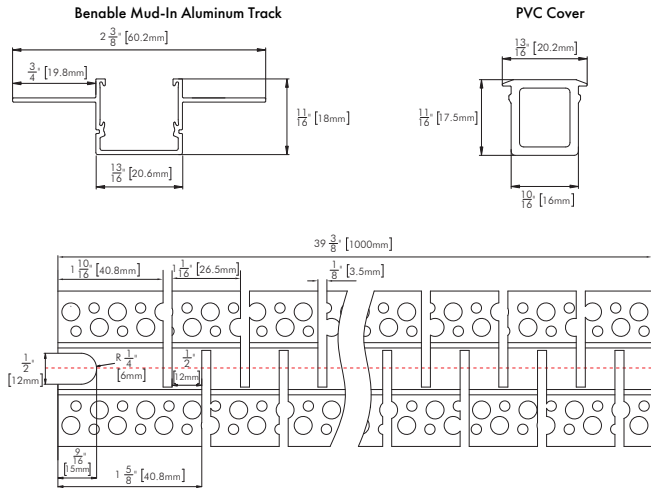

35

Bendable Mud-in Aluminum Track Installation

Instalación de riel de aluminio flexible para empotrar
Installation d'un rail en aluminium flexible à encastrer

Step 1: Mark the installation area and power input on the surface.

Step 2: Drill the slot along the marked outline. (Slot Width: 7/8" (21.5mm+0.5mm))

Step 3: Place the profile inside the slot and tighten the wings with screws. Make sure the screws are fastened to the wings in a staggered pattern.

Step 4: Install the PVC cover. The cover is made up of recyclable materials, so the color may vary from batch to batch.

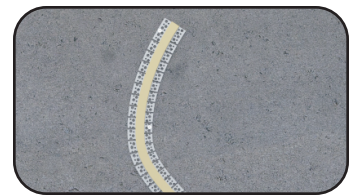
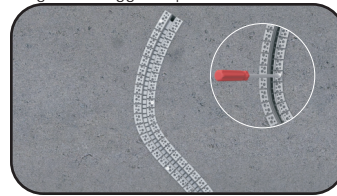
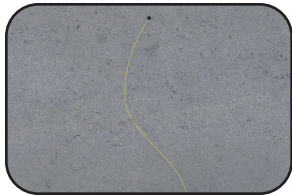

Step 5: Apply plaster over the wings and spread it until it's flush with the profile.

Step 6: Once dry, paint over the plastered wings.

Step 7: Remove the PVC cover and clean the slot.

Step 8: Test the light, then thread the cable through the cable exit slot.

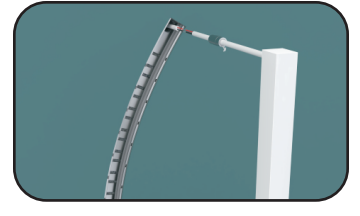
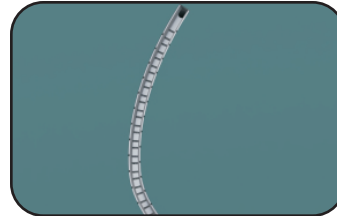
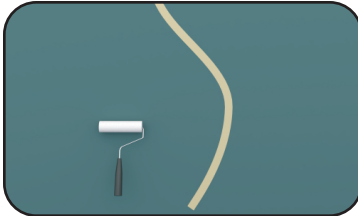
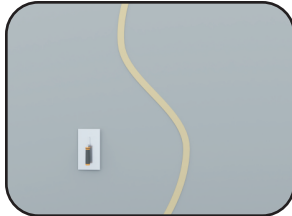

Step 9: Keep the insertion angle below 15°. Use your palm, not fingers to press the light into the profile, and install it vertically.

Step 10: Installation is complete.

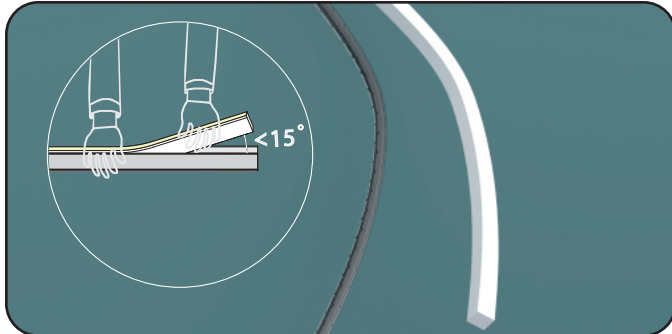

36

3D Flex Mini Direct View Unboxing

Desempaquetado del 3D Flex Mini Direct View
Déballage du 3D Flex Mini Direct View

Step 1: Inspect Packaging Before Opening.

- Check for visible shipping damage.
- If damaged, photograph the package before opening and report immediately.

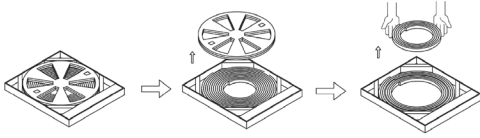

Step 3: Installation

- Hold the strip with two hands when moving.
- Do not install the 3D Flex Mini Direct View into the mounting channel without assistance, and never bend the strip beyond its specified limits.
- **We Recommend using two people to install the fixture.**



Step 2: Open Packaging and Remove Fixture Carefully

- Use a safety knife or scissors to cut tape, avoiding deep cuts that could damage the product inside.
- Do not use sharp tools near the 3D Flex Mini Direct View LED surface.

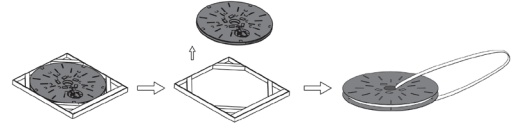

Step 4: Feeder Cable Care

- The 3D Flex Mini Direct View feed cable must be handled with care to maintain integrity. Excessive bending, pulling, or stress at the cable entry point can compromise internal connections and degrade the IP-rated seal, resulting in potential failure of the luminaire.

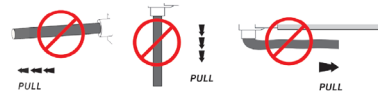

Avoid pulling or sharply bending the feed cable to protect internal connections and the ingress protection.

37

3D Flex Mini Direct View Installation

Instalación de la pantalla 3D Flex Mini de visión directa
Installation de l'écran 3D Flex Mini à visualisation directe

Step 1: Start installing with one end of the light. Make sure the light fits into track or bracket vertically.

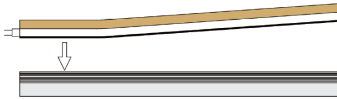

Step 3: Keep the angle between the 3D Flex Mini Direct View and mounting track under 30° to prevent damage to the fixture.

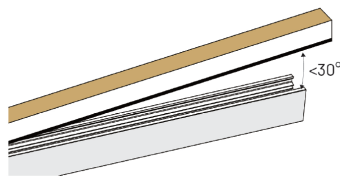

Step 2: Press the light all the way into the track or bracket by the palm of your hand instead of your fingers.

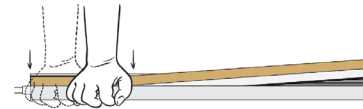

Step 3: Install the light from other end of the track when there is more than 2 meters left. This helps align the light with the track

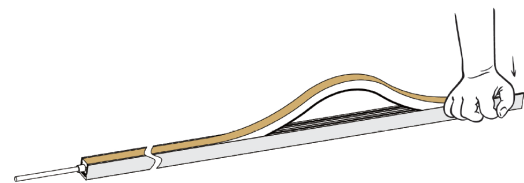

38

Removing 3D Flex Mini Direct View from Mounting Track

Cómo retirar el 3D Flex Mini Direct View del riel de montaje
Retrait du 3D Flex Mini Direct View du rail de montage

To remove the 3D Flex Mini Direct View from the mounting track or bracket, gently insert a flat-head screwdriver between the bottom of the 3D Flex Mini Direct View and the mounting surface, and carefully pry the fixture upward. Once the 3D Flex Mini Direct View begins to lift out of the bracket, stop using the screwdriver and use your hands to pull the fixture out, maintaining approximately a 30° angle during removal.

Handle the fixture carefully to avoid damaging the silicone jacket, which protects against water ingress. Do not repeatedly install the fixture. When installing two fixtures in parallel, maintain a 4" gap for proper heat dissipation.

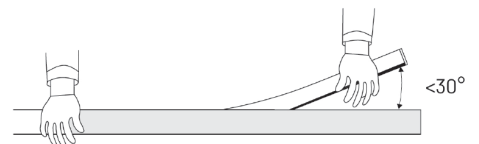
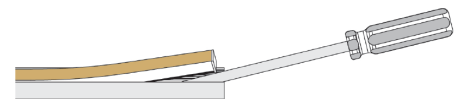

39

On/Off Wiring

Cableado de encendido y apagado
Câblage marche/arrêt

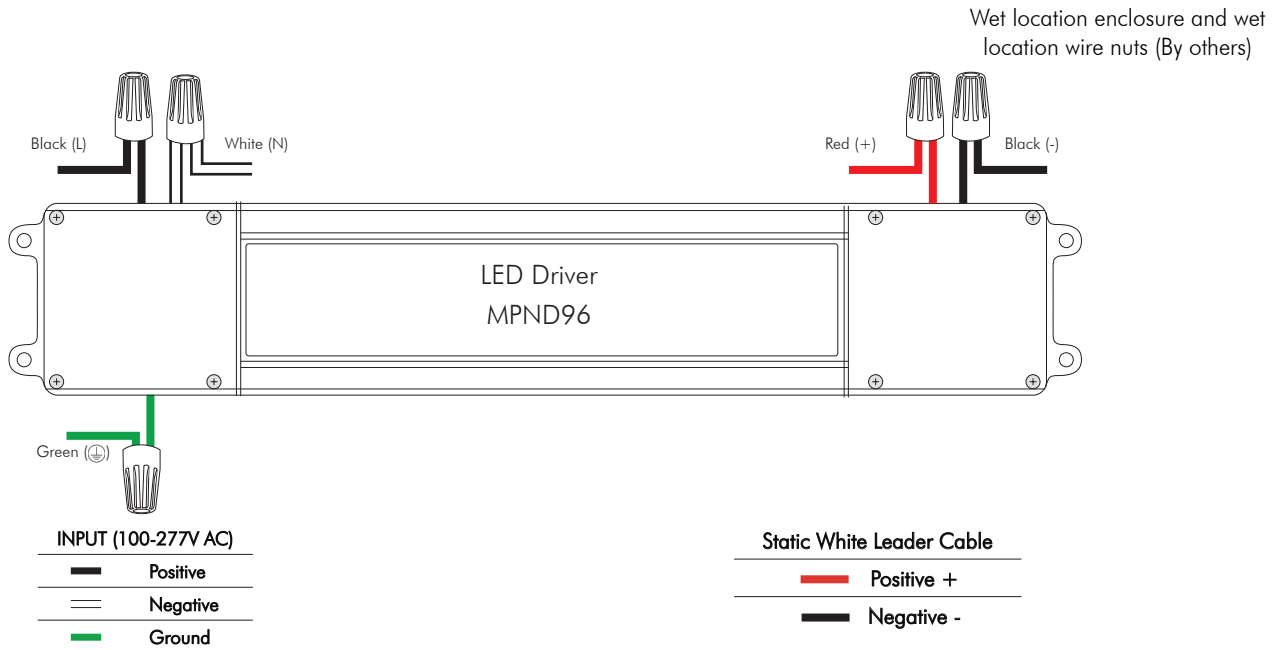

40

0-10V Wiring

Cableado de 0-10V
Câblage 0-10V

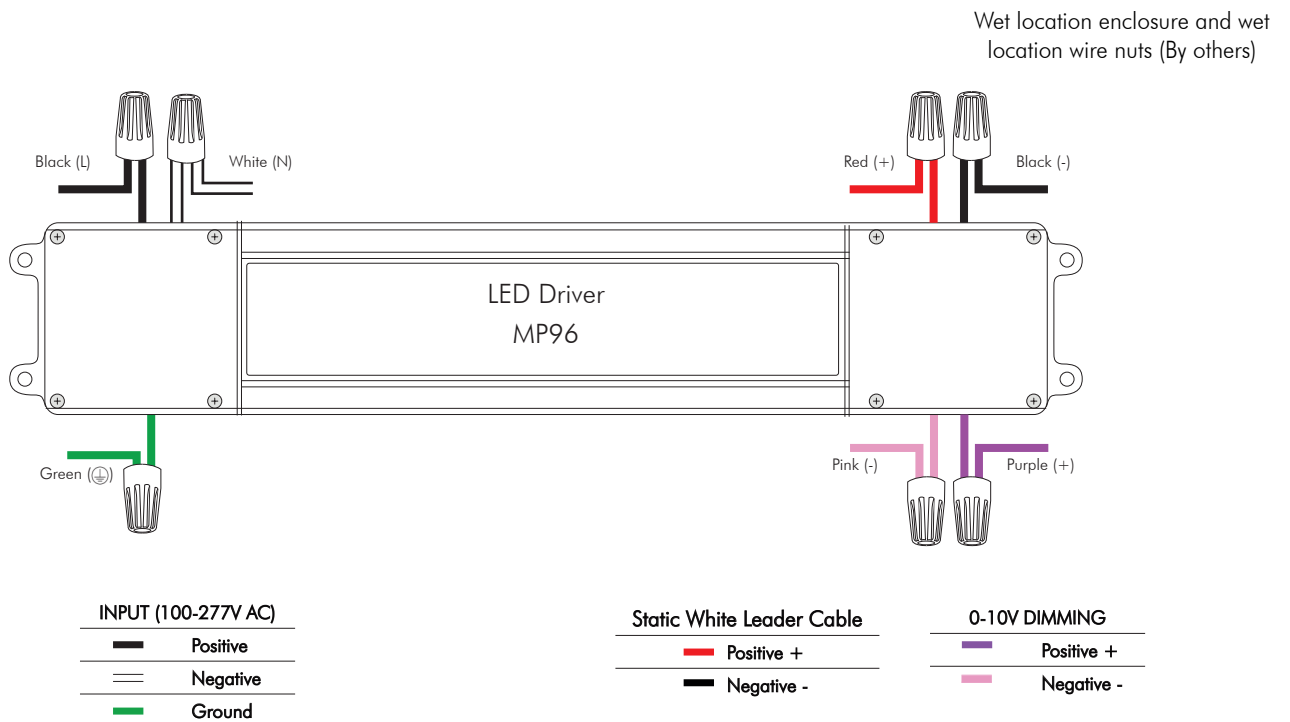

41

Connect leader cable

Conectar el cable líder
Connectez chef de fil

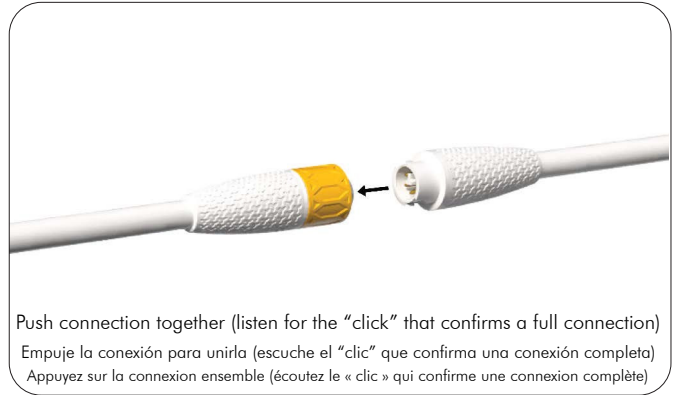
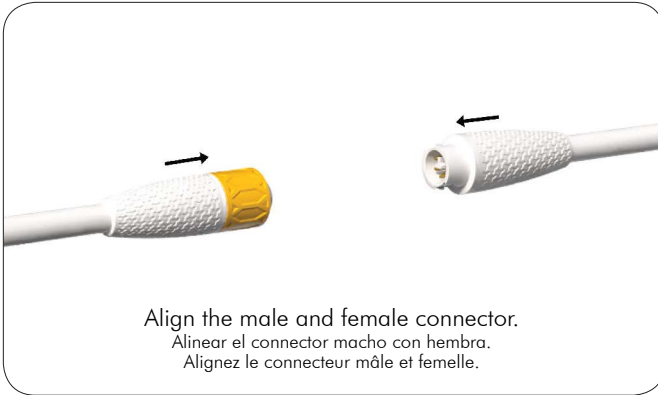

42

Disconnect leader cable

Desconecte el cable guía
Débrancher le câble principal

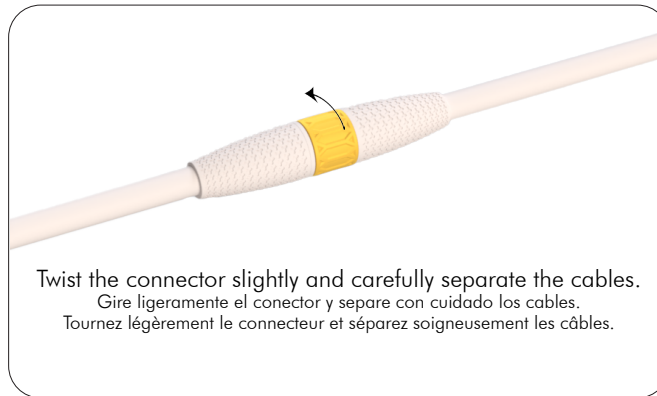

43

Connect terminator

Conectar terminador
Connectez terminateur

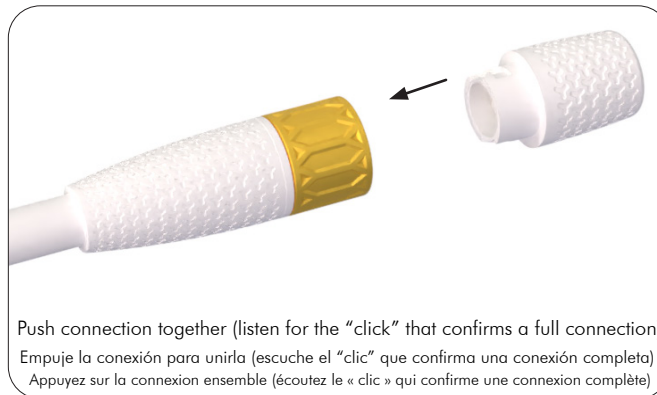

44

Available Connections

Conexiones disponibles
Connexions disponibles

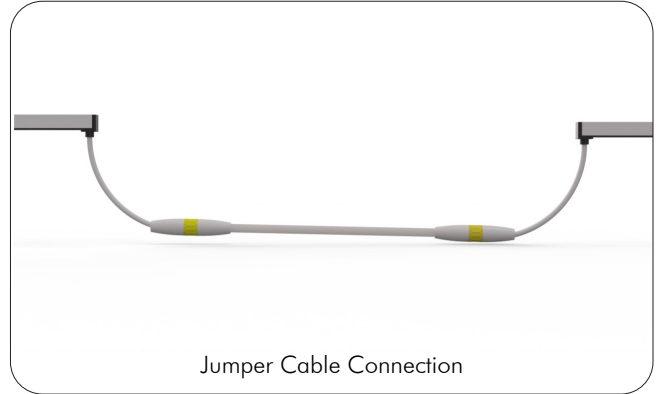
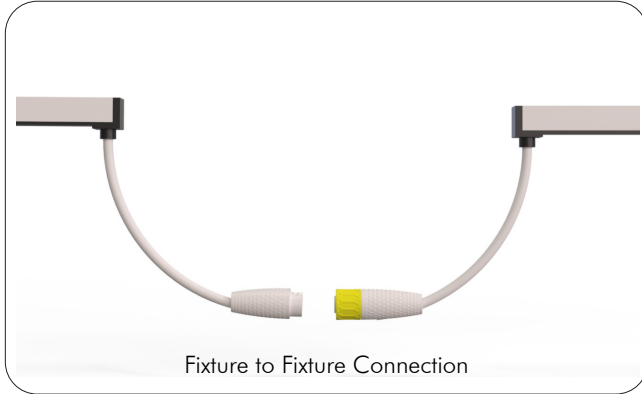

45

WARNINGS!

ADVERTENCIAS!
AVERTISSEMENTS!

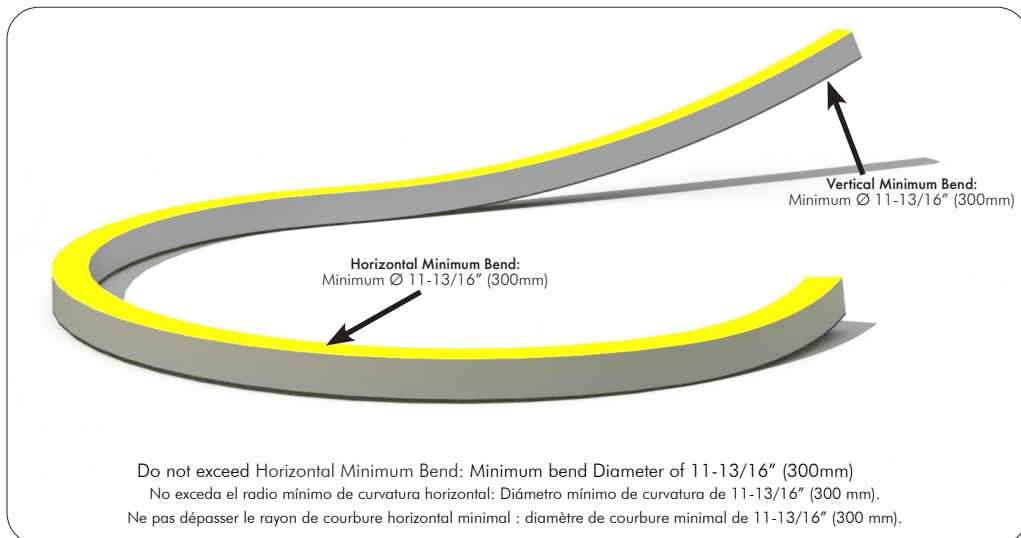
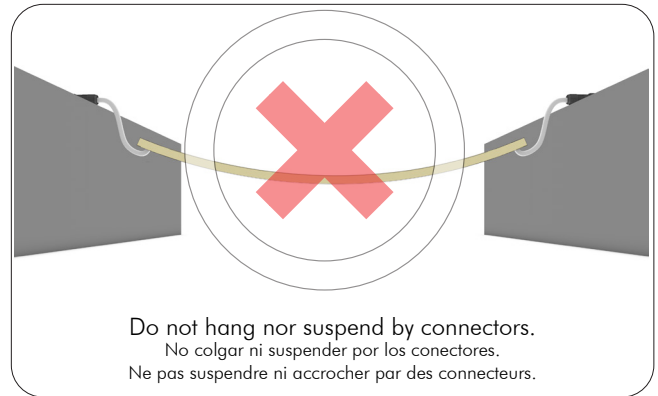
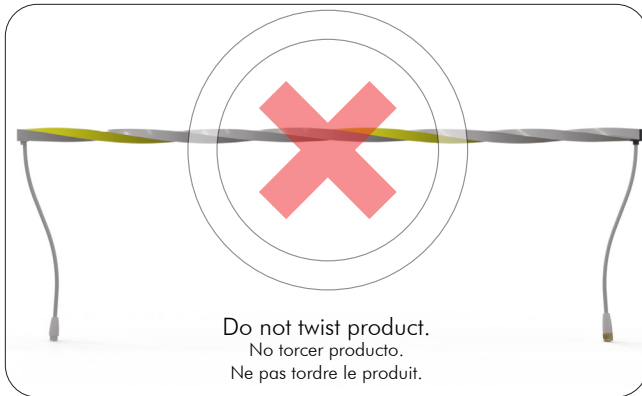

46

Silicone Mounting Track

Carril de montaje de silicona
Rail de montage en silicone

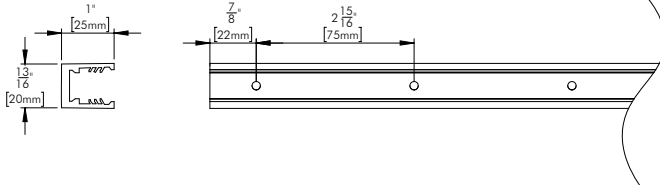

Bending Maximum	
Vertical Bending	Ø 11 13/16" (300mm)
Horizontal Bending	Ø 11 13/16" (300mm)

Length			
4 5/16" (110mm)	7 7/8" (200mm)	1' 7 11/16" (500mm)	3' 3 3/8" (1000mm)

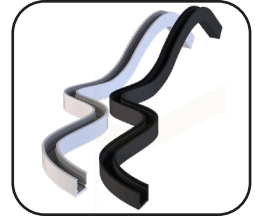

47

Silicone Mounting Bracket

Soporte de montaje de silicona
Support de montage en silicone

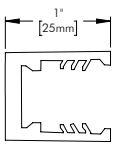

Length
1 3/8" (35mm)

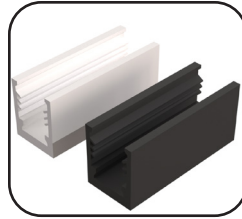

48

Stainless Steel Mounting Bracket

Soporte de montaje de acero inoxidable
Support de montage en acier inoxydable

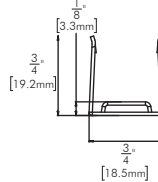

Length
1 3/8" (35mm)



49

Aluminum Bracket

Soporte de aluminio
Support en aluminium

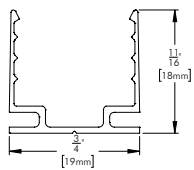

Length
1 3/8" (35mm)

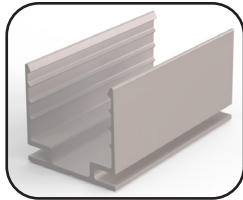

50

Fixed Aluminum Track

Riel fijo de aluminio
Voie fixe en aluminium

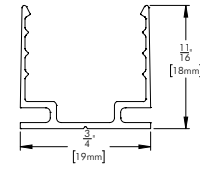

Length
1' 7 11/16" (500mm)
3' 3 3/8" (1000mm)
6' 6 3/4" (2000mm)

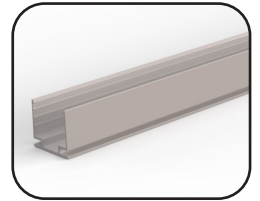

51

Flanged Aluminum Bracket

Soporte de aluminio con brida
Support en aluminium à bride

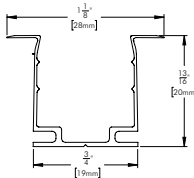

Length
1 3/8" (35mm)

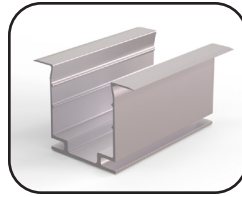

52

Fixed Flanged Aluminum Track

Riel de aluminio con brida fija
Rail en aluminium à bride fixe

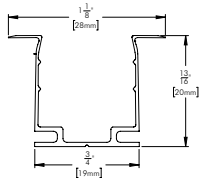

Length
1' 7 11/16" (500mm)
3' 3 3/8" (1000mm)
6' 6 3/4" (2000mm)

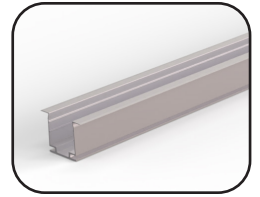

53

Serrated Aluminum Bracket

Soporte de aluminio dentado
Support en aluminium dentelé

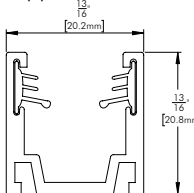

Length
13/16" (20mm)

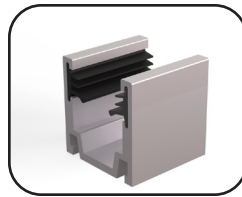

(Not suitable for high temperatures)

54

Fixed Serrated Aluminum Track

Pista de aluminio dentada
Rail en aluminium dentelé

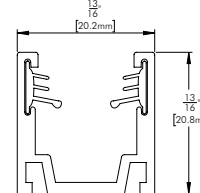

Length
1' 7 11/16" (500mm)
3' 3 3/8" (1000mm)
6' 6 3/4" (2000mm)

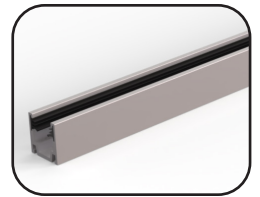

(Not suitable for high temperatures)

55

Horizontal Bendable Serrated Aluminum Track

Riel de aluminio dentado flexible horizontal
Rail horizontal flexible en aluminium dentelé

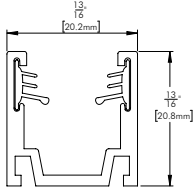

Length	
1' 7 11/16"	3' 3 3/8"
(500mm)	(1000mm)
Bending Maximum	
Ø 11 13/16" (300mm)	

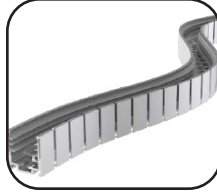

56

Flange Serrated Aluminum Bracket

Soporte de aluminio dentado con brida
Support en aluminium dentelé à brida

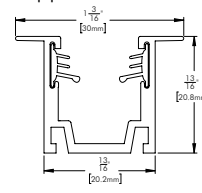

Length
13/16" (20mm)



(Not suitable for high temperatures)

57

Fixed Flange Serrated Aluminum Track

Riel de aluminio dentado con brida fija
Rail en aluminium dentelé à brida fixe

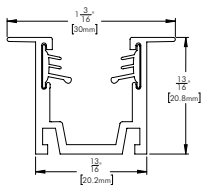

Length
1' 7 11/16"
(500mm)
3' 3 3/8"
(1000mm)
6' 6 3/4"
(2000mm)

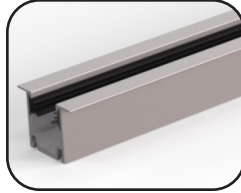

(Not suitable for high temperatures)

58

Joining Bracket for Aluminum Track

Conector de unión para riel de aluminio
Raccord de jonction pour rail en aluminium

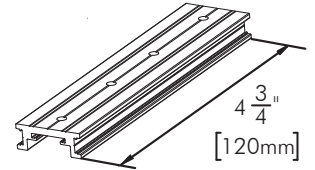
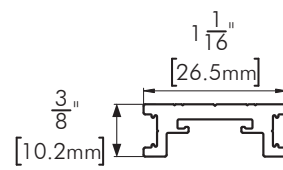

59

Surface and Suspended Fixed Mounted Raceway Aluminum Track

Pista de aluminio para canalización fija de superficie y suspendida
Piste en aluminium à montage fixe, en surface et suspendue

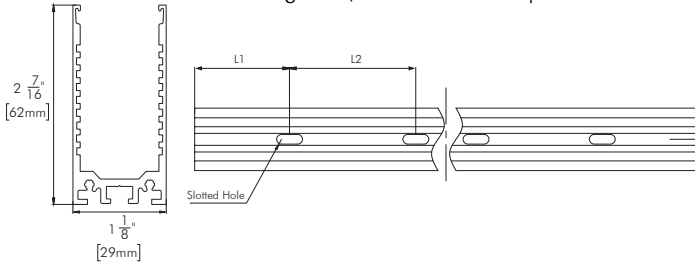

Length	L1	L2	Slotted Hole Size	# of Holes
1' 7 11/16"	1 15/16"	7 7/8"	0.18" 1/2in (4.5*12mm)	3
(500mm)	(50mm)			5
3' 3 3/8"	3 15/16"	(200mm)		10
(1000mm)	(100mm)			
6' 6 3/4"				
(2000mm)				

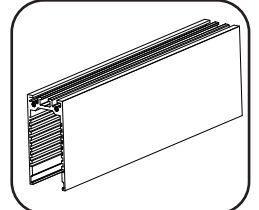

60

Raceway Serrated Track End Cap

Tapa de extremo para canaleta dentada
Embout dentelé pour goulotte

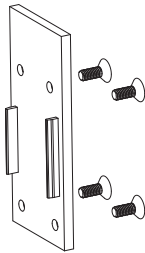

61

Raceway Serrated Track End Cap with Hole

Tapa de extremo dentada para canaleta con orificio
Embout de goulotte crantée avec trou

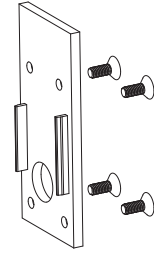

62

Pivot Mounting Bracket

Soporte de montaje pivotante
Support de montage pivotant

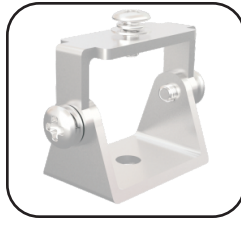
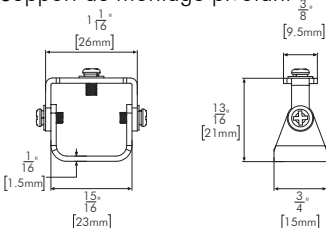

63

Rotary Locking Bracket

Soporte de bloqueo giratorio
Support de verrouillage rotatif

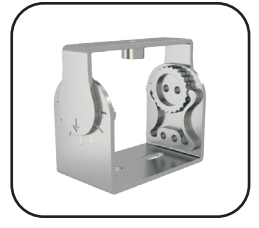
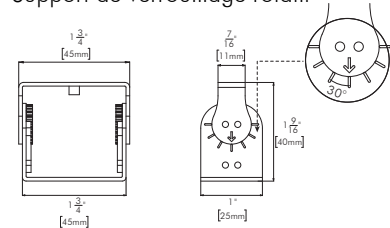

64

Side Mounting Bracket

Soporte de montaje lateral
Support de montage latéral

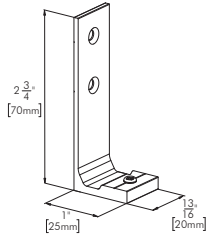

65

Ceiling Mounting Bracket

Soporte de montaje en techo
Support de montage au plafond

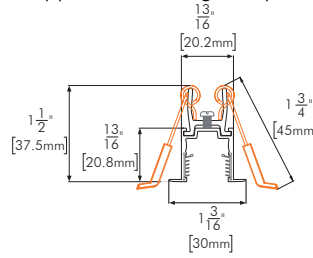

66

Cable Exit Mounting Brackets

Soportes de montaje para salida de cables
Supports de montage pour sortie de câble

Cable Exit Mounting Bracket Side Entry

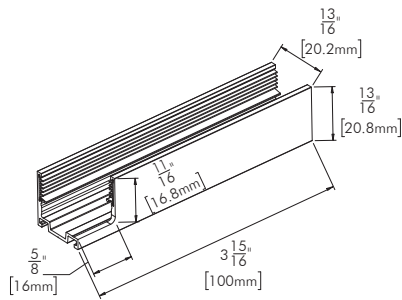

Cable Exit Mounting Bracket Bottom Entry

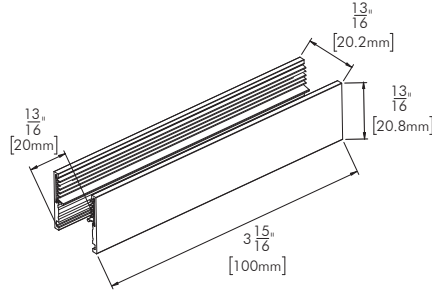

Cable Exit Mounting Bracket Middle Side Entry

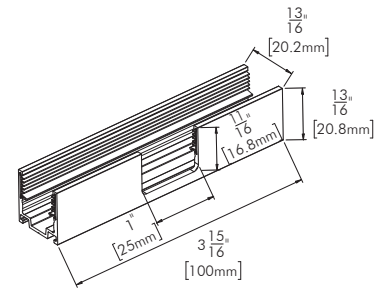

67

Bendable Mud-in Aluminum Track

Riel de aluminio flexible para empotrar en masilla
Rail en aluminium cintrable à encastrer

Bendable Mud-In Aluminum Track

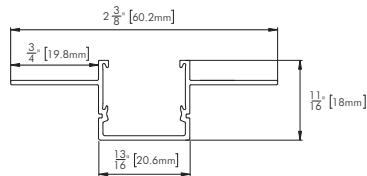

PVC Cover

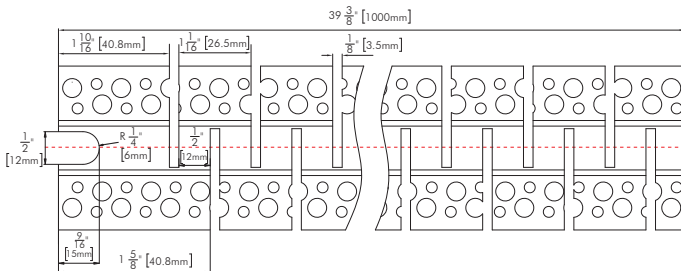
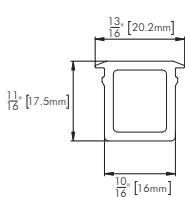

Bending Minimum Diameter

Vertical Bending	Ø 63" (1600mm)
Horizontal Bending	Ø 55.1" (1400mm)

Length

3' 3 3/8" (1000mm)

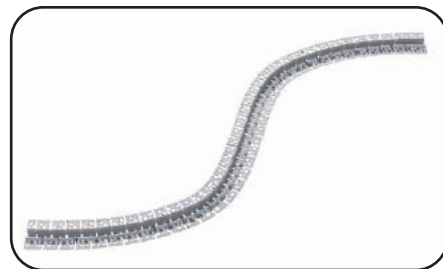

3D Flex Mini Direct View

Pantalla 3D Flex Mini de visión directa

Affichage direct 3D Flex Mini

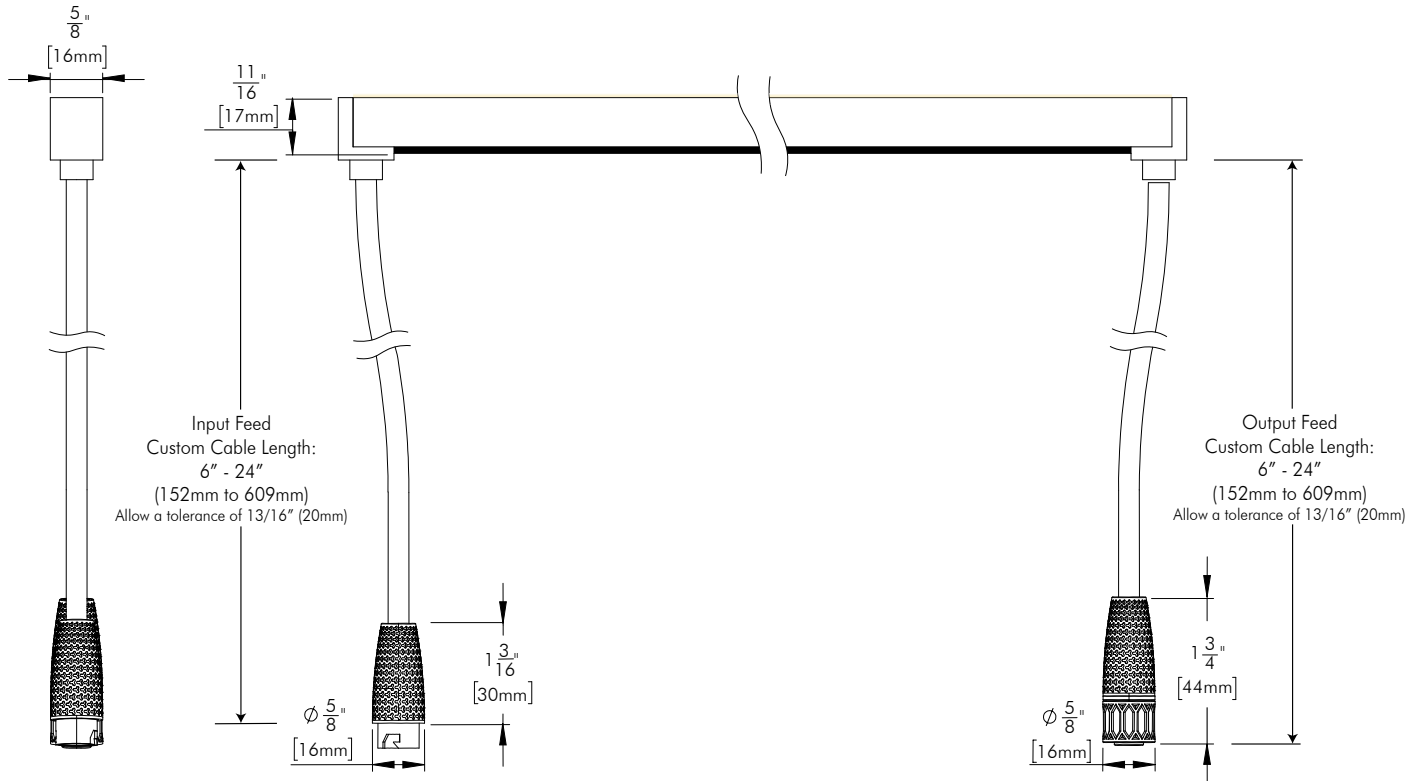

SPECIFICATIONS

PHYSICAL

Applications	Interior: Reflective coves, accent & contours, Indirect Ambient lighting, staircase & floor edge. Outdoor: Facade, perimeter, pathways, handrails, signage & wayfinding. Retail & Commercial: Shelf & display case, feature walls & brand elements. Creative & Decorative: Neon-style, hospitality mood lighting & furniture. Specialty: Automotive, marine, exhibits, stage, industrial & harsh environments.
Weight	3.5 oz (100g) / 1ft
Construction	Silicone
Thermal Management	Cool to Touch, Free Air Convection
Fixture Connections	Injection-moulded Leader and Jumper cables
Operating Temperature	-40°F to 131°F (-40°C to 55°C)
Ambient Installation Temp	> -40°F (> -40°C)
Storage Temperature	-40°~140°F (-40~60°C)
Environment	Exterior, Interior UV Protected
IP Rating	IP67
Vibration	3G - ANSI C136.31 for bridge applications
IK Rating	IK08

OUTPUT

Beam Angle	113°x113°
CCT	2200K, 2400K, 2700K, 3000K, 3500K, 4000K
Lumen Maintenance	L70 - 50,000 Hours
Testing Data	LM79-19, LM-80-15

DIMENSIONS AND WEIGHT

Fixture Lengths with Side Feed (L or R)	From 7 1/8" (181.6mm) to 32' 9 1/4" (9,988mm)*
Fixture Lengths with Bottom Feed	From 7 1/8" (181.6mm) to 32' 9 1/4" (9,988mm)*
Fixture Lengths with End Feed	From 8" (203.6mm) to 32' 10 1/16" (10,010mm)
Width	5/8" (16mm)
Height	11/16" (17mm)
Minimum Vertical Bend	11 13/16" (300mm)
Minimum Horizontal Bend	11 13/16" (300mm)

ELECTRICAL

Input Voltage	24V DC
Power Consumption	2.43W/ft* (0.101A) *Varies based on length and run of driver.

MAX CONTINUOUS RUN

96W Driver	32ft 10 1/16" (10010mm)*
Fixture Connections	Limited to 5 fixture connections
*Note: If the run exceeds 32 ft, either plan for two runs powered from opposite ends that meet in the middle to create a continuous line of light, or power a single run from both ends.	

STANDARDS & CERTIFICATIONS

  	Tested to UL & CSA by UL, for Use in USA & CANADA. CE & RoHS Compliant.
Certification	
Environment	Wet Location
Warranty	3 Year Limited Warranty

⚠ Do not attempt to install or use the product until installation is fully read and understood

No intente instalar o utilizar el producto sin antes leer y comprender las instrucciones!

Ne tentez pas d'installer ou d'utiliser le produit jusqu'à ce que l'installation est entièrement lu et compris!

⚠ Do not use the product if jacket or power cables are damaged.

No utilice el producto si la cobertura exterior o cables de energía están defectuosos!

Ne pas utiliser le produit si la veste ou les câbles d'alimentation sont endommagés!

⚠ Only use current/voltage listed for product.

Utilice únicamente la corriente/voltaje indicados para el producto.

Utilisez uniquement le courant/la tension indiqué pour le produit.

⚠ De-energized system before connecting or disconnecting product.

Desactive la energía del sistema antes de conectar o desconectar el producto.

Système hors tension avant de connecter ou de déconnecter le produit

⚠ Maximum recommended driver-to-fixture distance is 5ft. Moda-manufactured power leads up to 6ft are tested and approved for use only as provided. Any additional extension, modification, or use of third-party cabling beyond this configuration is not recommended and will void the warranty.

La distancia máxima recomendada entre el controlador y la luminaria es de 1,5 metros (5 pies). Los cables de alimentación fabricados por Moda, de hasta 1,8 metros (6 pies), están probados y aprobados para su uso únicamente en las condiciones especificadas. No se recomienda ninguna extensión, modificación o uso de cables de terceros que excedan esta configuración, ya que anulará la garantía.

La distance maximale recommandée entre le transformateur et le luminaire est de 1,5 mètre (5 pieds). Les câbles d'alimentation fabriqués par Moda, d'une longueur maximale de 1,8 mètre (6 pieds), sont testés et homologués pour une utilisation conforme aux instructions. Toute rallonge, modification ou utilisation de câbles tiers au-delà de cette configuration est déconseillée et annulera la garantie.

⚠ Do not bend product beyond the maximum bend diameter listed on the installation guide.

No doble el producto más allá del diámetro de curvatura máximo indicado en la guía de instalación.

Ne pliez pas le produit au-delà du diamètre de courbure maximal indiqué dans le guide d'installation.

⚠ Ensure all connections are fully seated and perform a pull test before powering on to prevent electrical arcing.

Asegúrese de que todas las conexiones estén completamente asentadas y realice una prueba de tracción antes de encender para evitar un arco eléctrico. Assurez-vous que toutes les connexions sont bien en place et effectuez un test de traction avant la mise sous tension pour éviter les arcs électriques.

⚠ Do not coat the product in paint. This will ruin the product and void warranty.

No cubra el producto en pintura! Esto va a arruinar el producto y anular la garantía.

Ne pas enduire le produit dans la peinture! Cela va ruiner le produit et annuler la garantie!

⚠ Please make sure to install in accordance with the local code.

Por favor asegúrese de instalar de acuerdo con el código local.

Faire S'il vous plaît veillez à installer en conformité avec le code local.

⚠ Do not cut or modify the product.

No corte ni modifique el producto.

Ne pas couper ni modifier le produit.

⚠ Use only compatible Moda Light drivers.

Utilice únicamente controladores Moda Light compatibles.

Utilisez uniquement des pilotes Moda Light compatibles.

⚠ Do not stand on product during installation.

No se pare sobre el producto durante la instalación.

Ne pas se tenir debout sur le produit pendant l'installation.

⚠ Do not exceed maximum run length specified for multiple pieces wired in line.

No exceda la longitud máxima especificada para piezas múltiples cableadas en línea.

Ne pas dépasser la longueur maximale spécifiée pour plusieurs pièces câblées en ligne.